

TRUFAST SCREWS  
@ 6" O.C. U.N.O.

8d NAILS @ 6" O.C.

7/16" OSB SPLINE

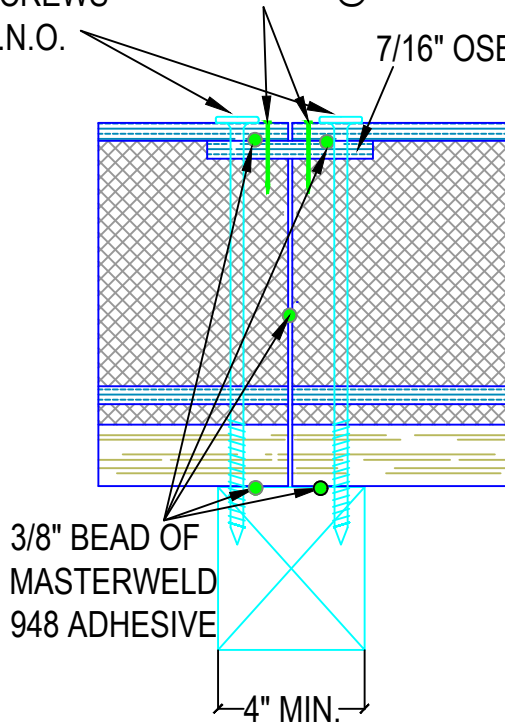

END JOINTS MUST FALL OVER SUPPORTING MEMBERS  
MINIMUM BEARING IS 2" PER PANEL

**1** TECTUM V - OVER SUPPORT  
Scale: N.T.S.

8d NAILS @ 6" O.C.

7/16" OSB SPLINE

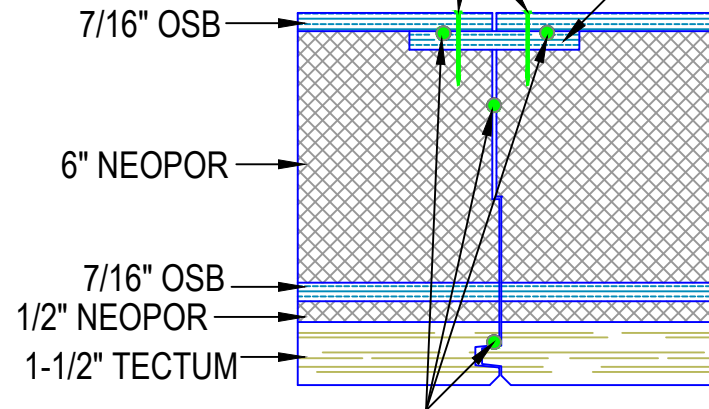

CONTINUOUS PERIMETER SUPPORT  
BY OTHER REQUIRED. MINIMUM BEARING IS 3".  
SCREW PANELS @ 6" O.C. ALONG PERIMETER.

**2** TECTUM V - TONGUE AND GROOVE  
Scale: N.T.S.

These drawings show typical conditions in which the Armstrong product depicted is installed. They are not a substitute for an architect's or engineer's plan and do not reflect the unique requirements of local building codes, laws, statutes, ordinances, rules and regulations (Legal Requirements) that may be applicable for a particular installation. Armstrong does not warrant, and assumes no liability for the accuracy or completeness of the drawings for a particular installation or their fitness for a particular purpose. The user is advised to consult with a duly licensed architect or engineer in the particular locale of the installation to assure compliance with all Legal Requirements. Armstrong is not licensed to provide professional architecture or engineering design services.

PROJECT NAME: <b>TECTUM V DETAILS</b>		
DATE: 10-30-17	SCALE: N.T.S.	PROJECT NO.: XXX
REV:	DATE:	DESC.: 2052 - TECTUM V DETAILS
REV:	DATE:	



DRAWN BY: KBD	PROJECT MNGR: XXX	SHEET
		<b>SK1</b>
		1 OF 1