

TECTUM ROOF DECK OVER STEEL

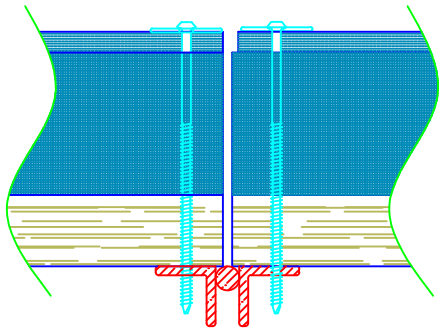

TECTUM III, E, AND NS DECK USES DEKFAST #14 SCREWS WITH A 1 1/2" WASHER OR TRUFast HD SCREWS. PRE DRILLING IS REQUIRED FOR 1/8" THICK OR THICKER STEEL.

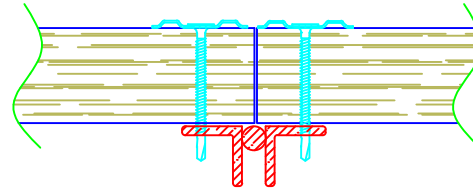

TECTUM I DECK USES DEKFAST #14 SCREWS. A 2" DIAMETER WASHER IS REQUIRED.

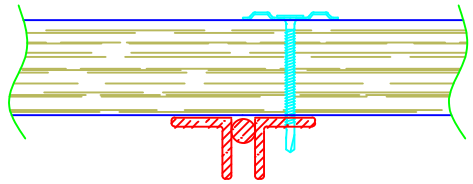

ONE ROW OF SCREWS IS REQUIRED AT INTERMEDIATE SUPPORTS.

NOTE : A 3/8" BEAD OF CONSTRUCTION ADHESIVE IS REQUIRED WHEN SPECIFIED.

1 DECK SCREWED TO STEEL
Scale: N.T.S.

These drawings show typical conditions in which the Armstrong product depicted is installed. They are not a substitute for an architect's or engineer's plan and do not reflect the unique requirements of local building codes, laws, statutes, ordinances, rules and regulations (Legal Requirements) that may be applicable for a particular installation. Armstrong does not warrant, and assumes no liability for the accuracy or completeness of the drawings for a particular installation or their fitness for a particular purpose. The user is advised to consult with a duly licensed architect or engineer in the particular locale of the installation to assure compliance with all Legal Requirements. Armstrong is not licensed to provide professional architecture or engineering design services.

PROJECT NAME: DECK SCREWED TO STEEL		
DATE: 10-16-17	SCALE: N.T.S.	PROJECT NO.: XXX
REV:	DATE:	DESC.: 2005 - DECK SCREWED TO STEEL
REV:	DATE:	



DRAWN BY: KBD	PROJECT MNGR: XXX	SHEET
		SK1
		1 OF 1